

1 2 3 4 5 6 7 8

REV	LOCATIONS	DESCRIPTION	DATE	REVISER	APPD
1		Remove tube packaging	21/JUN/23	MATT	LEO
2	△	Update dimensions and tolerances	17/JAN/24	MATT	LEO
3	△	Update dimensions	29/JUL/25	MATT	LEO

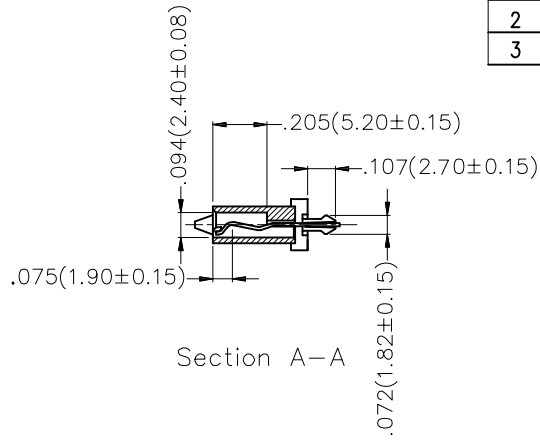
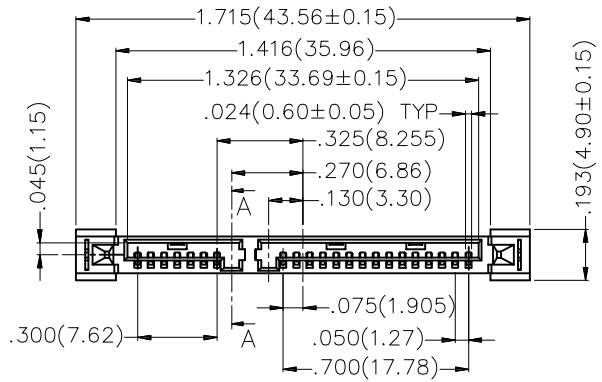

SPECIFICATIONS

Electrical
 Current Rating: 1.0A AC(rms)/DC
 Contact Resistance: 20 mΩ Max
 Insulation Resistance: 800 MΩ Min
 Withstanding Voltage: 600V AC r.m.s
 Temperature Range-Operating: -40°C~+85°C

Material and Plating
 Housing: LCP (UL94V-0) Black
 Contact: Phosphor Bronze, T=0.30mm/Selective gold on contact area, tin on tail.
 PEG: Brass/Tin Plated

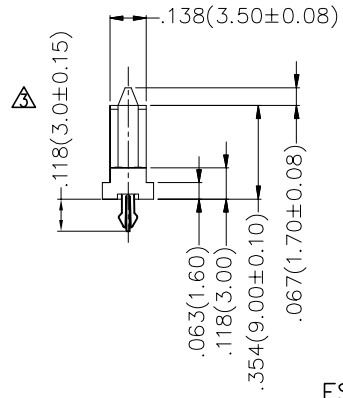
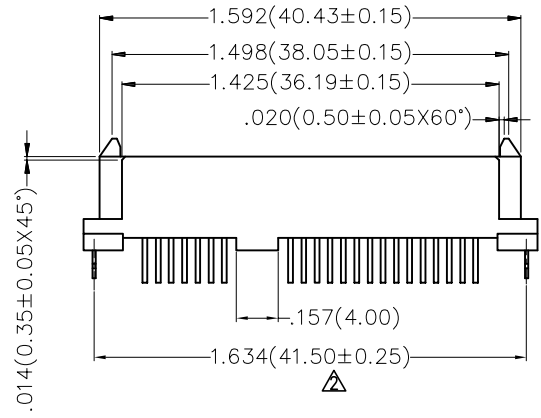

Ordering Information

FST 22 11 - F D S 3 XX 3 K6 K
 1 2 3 4 5 6 7 8 9 10 11

1 Category FST-SATA	2 Circuits 22-7+15	3 Distinction No. 11	4 Type F-Female	5 Assembly Layout D-DIP	6 Entry Angle S-180° Vertical
7 Plating 3-Selective gold on contact area, tin on tail.	8 Thickness of Plating 00-Gold Plating 03-3μ"..... Custom Plate Available	9 Material-Resin 3-LCP	10 Color-Resin K6-Black	11 Packaging K-Tray	

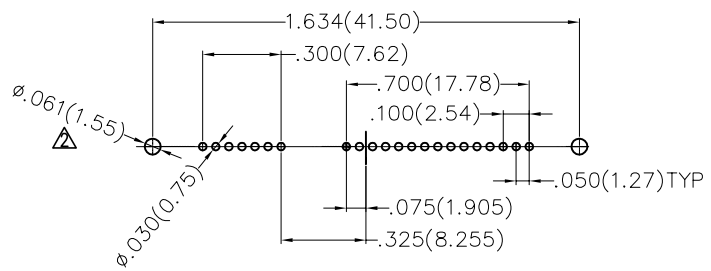

Recommended P.C.Board Layout
 General Tolerances: ±0.05mm

THIRD ANGLE PROJECTION	GENERAL TOLERANCES (UNLESS SPECIFIED)		APPROVE BY FRANK	DATE 21/JUL/17	PART NO. FST2211-FDS3XX3K6K	ITEM NO. FST2211	 Building Technology Cornerstone
	DESIGN UNITS Inch (metric)	X.±.012(0.30) X.X±.008(0.20) X.XX±.006(0.15) X.XXX±.004(0.10)	X'±5' .X'±2' .XX'±1' .XXX'±0.5'	CHECKED BY CHERRY	DATE 21/JUL/17	TITLE SATA Connector 7+15 Circuits Female (DIP)	
SCALE 5:1	SIZE A4	DRAWN BY LXF		DATE 21/JUL/17	THIS DRAWING CONTAINS INFORMATION THAT IS PROPRIETARY TO TXGA INDUSTRIAL ELECTRONICS(S.Z)CO.,LTD AND SHOULD NOT BE USED WITHOUT WRITTEN PERMISSION		

1 2 3 4 5 6 7 8